

BeadWash C-Pro Protocol Software

SEPAX C-PRO CELL PROCESSING SYSTEM

BeadWash C-Pro is a protocol software to process apheresis products in combination with Sepax™ C-Pro instrument and CT-60.1 or CT-90.1 kit. BeadWash C-Pro enables a reproducible and user-independent procedure. It allows you to choose if and how to concentrate, deplete platelets, incubate magnetic beads, and wash cell fractions obtained from apheresis product. With the wide range of volumes and parameters you can customize BeadWash C-Pro to fit your needs.

- **Concentrate:** simplify cellular volume management by performing volume reduction cycles when needed. Process initial volumes up to 880 mL
- **Deplete platelets:** effectively remove platelets from your apheresis product by selecting appropriate parameters for the dedicated washing cycles
- **Incubate magnetic beads:** add beads to your cells and reach the desired volume before mixing them for the time you've defined
- **Wash cells:** effectively remove debris and excess reagents and resuspend your cells in fresh medium. You can modify the two washing profiles, before and after the incubation step, independently

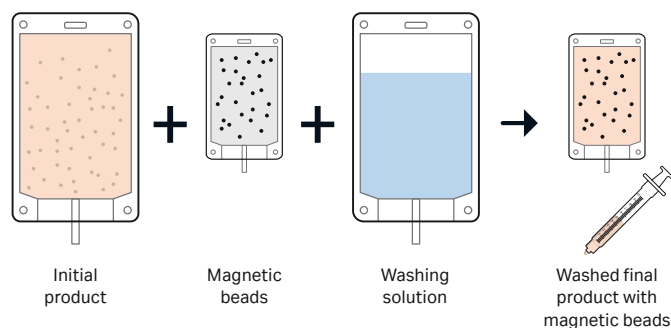

Fig 2. Processing operations available in BeadWash C-Pro.

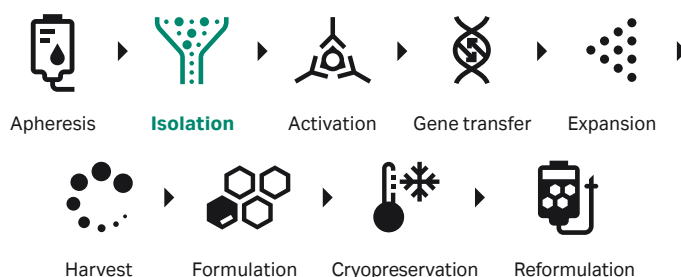

Fig 1. General workflow for cell therapy manufacturing. BeadWash C-Pro performs operations within the step highlighted in green.

Key features

Feature	Description
Initial volume	20 to 880 mL*
Initial dilution	Set a dilution up to 3 times the initial volume, at the desired speed – 10 to 120 mL/min
Configurable wash cycles before and after incubation	Independently select g-force – 85 to 800 × g, time – 2 to 20 min, and number of cycles – 0 to 4, for each step
Configurable incubation step	Define the volume of reagent to add – 1 to 200 mL, the incubation volume – 10 to 220 mL, the incubation time – 0 to 180 min, and the pause time between mixing – 5 to 10 s
Selectable final volume	8 to 500 mL ± 5 mL†
Average processing time	77 min‡
Average CD34 ⁺ recovery	> 80%‡
Average CD34 ⁺ viability	> 95%‡

* The CT-90.1 kit is only validated for initial volumes up to 220 mL. Higher volumes must be validated by the user.

† CT-90.1 kit required if final volume less than 20 mL.

‡ Indication only. Performance depends on user/product configuration.

Ordering information

Product	Product code
BeadWash C-Pro Protocol Software	29286433
<ul style="list-style-type: none">Product is supplied as a USB drive containing the protocol installer	

Related products	Product code
Sepax C-Pro Cell Processing Instrument	29264741
CT-60.1 Sepax C-Pro Cell Processing Kit	29264739
CT-90.1 Sepax C-Pro Cell Processing Kit	29264740

cytiva.com/celltherapy

Cytiva and the Drop logo are trademarks of Global Life Sciences IP Holdco LLC or an affiliate. Sepax is a trademark of Global Life Sciences Solutions USA LLC or an affiliate doing business as Cytiva.

© 2020 Cytiva

All goods and services are sold subject to the terms and conditions of sale of the supplying company operating within the Cytiva business. A copy of those terms and conditions is available on request. Contact your local Cytiva representative for the most current information.

For local office contact information, visit cytiva.com/contact

CY13887-01Sep20-DF

